

- e. What is the landed cost per unit to purchase and ship to the designated community?

The landed costs, to the high-water mark (does not include costs to transport to site and setup):

\$10,175,550 (22 units) – average cost per unit of \$462,525

- f. What are the approximate monthly utility costs (water, electricity, sewage, etc.) for each modular unit?

We don't have data as these are new units.

- g. Which entity is responsible for paying the monthly utility costs?

NCCD is responsible for monthly utility bills during the period of time they occupy these duplexes.

Question:

2. With respect to the Nunavut Housing Corporation's announcement of June 6, 2023, concerning the purchase of modular units from Sakku Innovative Building Solutions for the purpose of "transitional housing or staff housing for Department of Family Services critical staff":

- a. How many modular units have been purchased?

Four (4) duplexes for a total of 8 units have been purchased.

- b. What is the design of each unit?

Attached below as Appendix A is a floor that is currently being used as the construction staff layout. However we will work with Family Services to ensure that any modifications will be completed.

- c. What is the community allocation of the modular units?

A single duplex or 2 units in each of the following communities: Kinngait, Pangnirtung, Sanikiluaq, and Sanirajak.

- d. What is the status of delivery of each modular unit?

All 4 duplexes have been delivered to each community via marine supply in fall 2023.

- e. What is the landed cost per unit to purchase and ship to the designated community?

The landed costs to the high water mark (does not include costs to transport to site and setup):

\$10,175,550 (22 units) – average cost per unit of \$462,525

- f. What are the approximate monthly utility costs (water, electricity, sewage, etc.) for each modular unit?

We don't have data as these are new units.

- g. Which entity is responsible for paying the monthly utility costs?

Dept of Family Services will be responsible for monthly utility bills as the tenant of these duplexes.

APPENDIX A

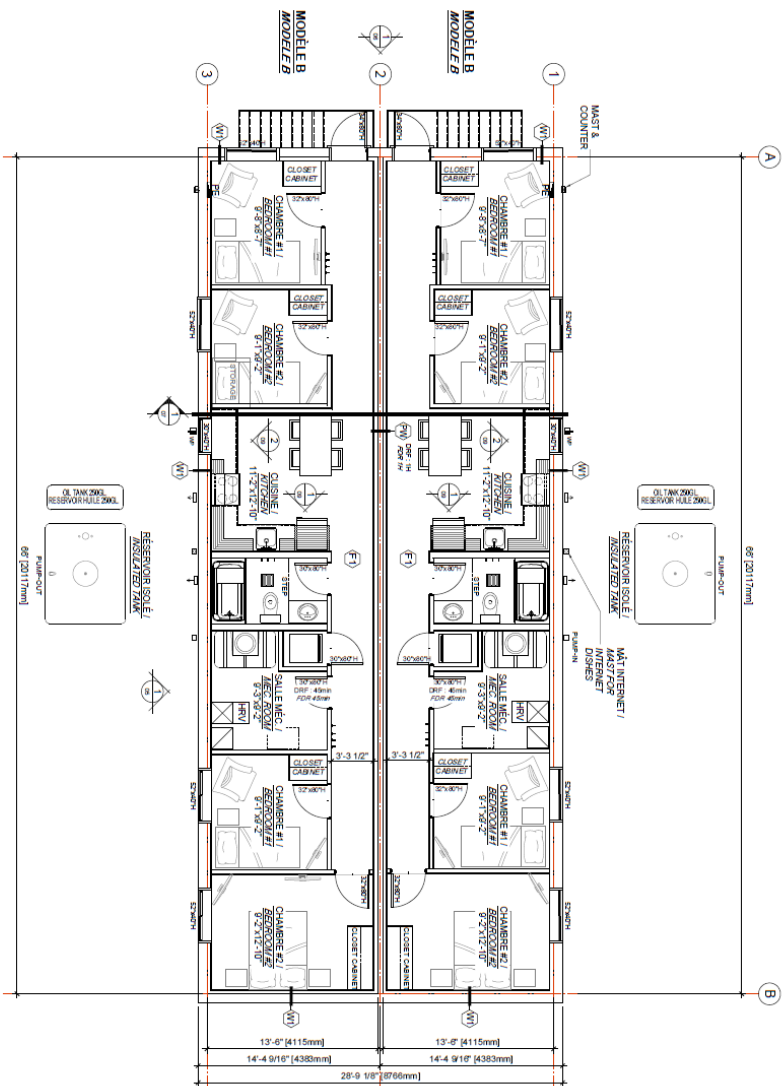

2 UNITÉS DE 4 CHAMBRES DANS UN DUPLEX (B)
 ÉCHELLE: 1/8" = 1'-0"

Rg Solution
 301, Chemin du Parc Industriel
 Saint-Jean, Q.C. J9V 4J0
 Courriel: info@rgsolution.ca
 Tél: (418)-486-2628
 BATA MODULAIRE, PAVILION MODULAIRE, TENDON MODULAIRE, TRUCK MODULAIRE, FAÇONNÉ MODULAIRE
 Tél: (418)-486-2773

Note:
 ANY REPRODUCTIONS PROHIBITED WITHOUT
 WRITTEN PERMISSION FROM RGSOLUTION
 The copyright of this plan has the sole right to
 produce or reproduce all or any part of the work in any
 material form, to perform or to use or to present in its
 totality or in part.

| | | | |
|------------------------------------|---------------------------|---------------------------------|--------------|
| <i>Client/ Customer:</i> | NCC | <i>Dessiné par/</i> | A. GOSSELIN |
| <i>Projet/ Project:</i> | DORTOIRS / DORMITORIES | <i>Échelle/ Scale:</i> | 1/8" = 1'-0" |
| <i># Soumission/ Submission #:</i> | SMO208-V10 | <i>Électrichité conçue par/</i> | N/A |
| <i>Projet/ Project:</i> | DORTOIRS / DORMITORIES | <i>Électrichité conçue par/</i> | N/A |
| <i># Soumission/ Submission #:</i> | SMO208-V10 | <i>Électrichité conçue par/</i> | N/A |
| <i>Projet/ Project:</i> | QUOTATION | <i>Projet manager:</i> | IMARCEAU |
| <i>Duquel/ From:</i> | SMO208-V11.dwg | <i>Dirigé par/</i> | N. CHAMPAGNE |
| <i>Échelle/ Scale:</i> | 1/8" = 1'-0" | <i>Dirigé par/</i> | N. CHAMPAGNE |
| <i>Électrichité conçue par/</i> | N/A | <i>Dirigé par/</i> | N. CHAMPAGNE |
| <i>Projet manager:</i> | IMARCEAU | <i>Dirigé par/</i> | N. CHAMPAGNE |

Échelle/ Scale: 1/8" = 1'-0"
Date: 23 FEVRIER 2023
Page: 04 / 12